

**LEGEND**

- Interstate/Ramp Construction
- Municipal Street Construction
- Raised Median Construction
- Bridge Construction
- Sidewalk
- Retaining Wall Construction
- Existing ROW/Property Line
- Anticipated ROW Impact
- X Proposed Driveway Closure or Relocation

**NORTH**  
SCALE  
1:250

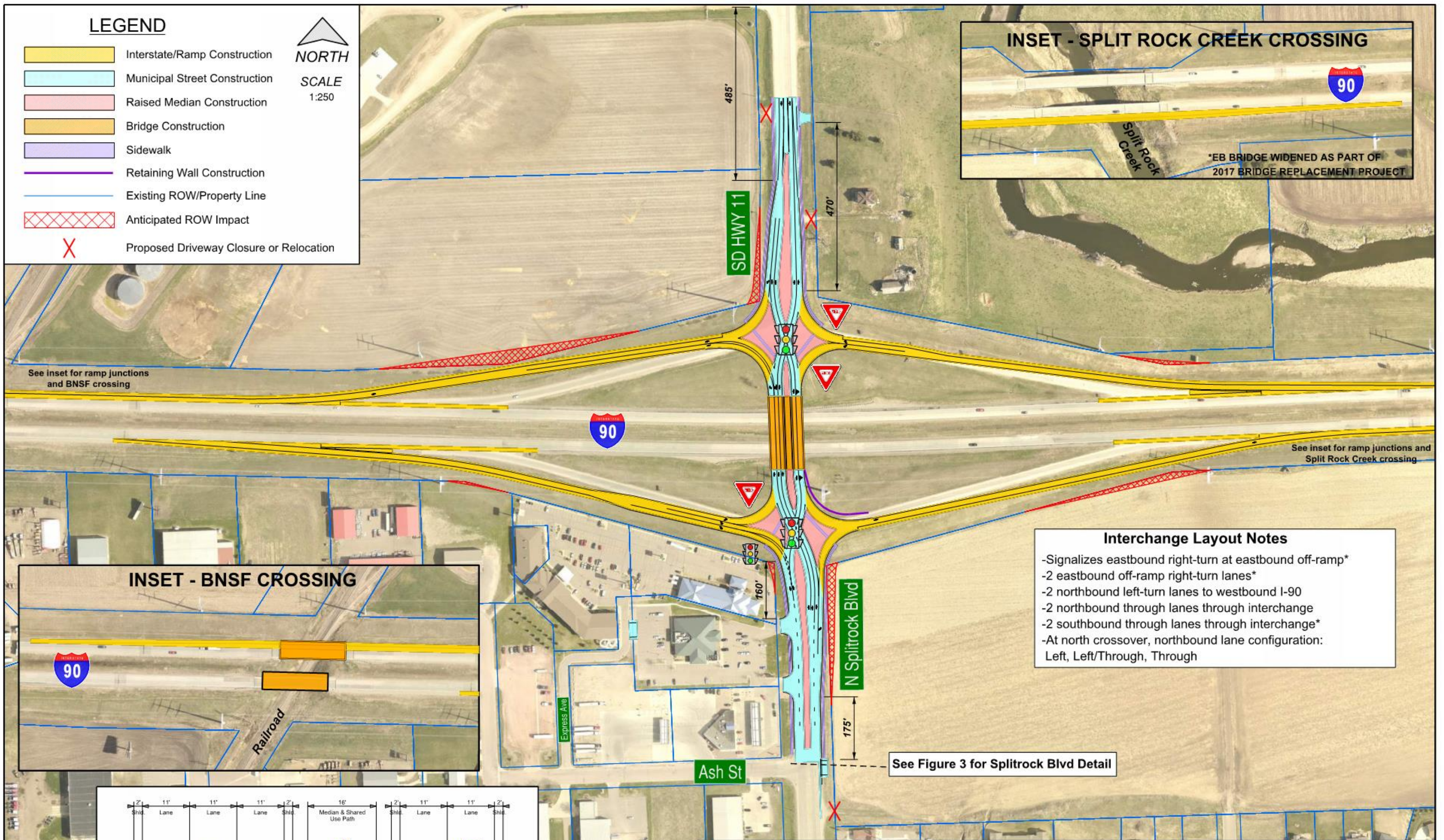

See inset for ramp junctions and BNSF crossing

See inset for ramp junctions and Split Rock Creek crossing

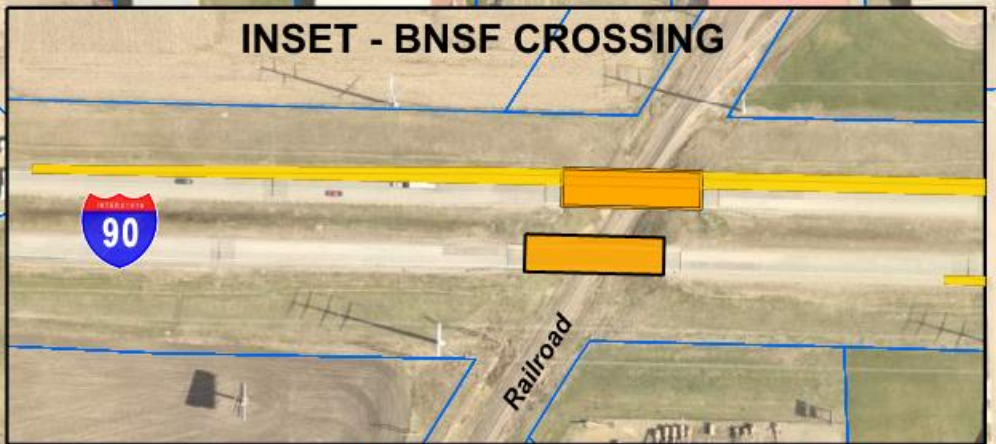

- Interchange Layout Notes**
- Signalizes eastbound right-turn at eastbound off-ramp\*
  - 2 eastbound off-ramp right-turn lanes\*
  - 2 northbound left-turn lanes to westbound I-90
  - 2 northbound through lanes through interchange
  - 2 southbound through lanes through interchange\*
  - At north crossover, northbound lane configuration: Left, Left/Through, Through

See Figure 3 for Splitrock Blvd Detail

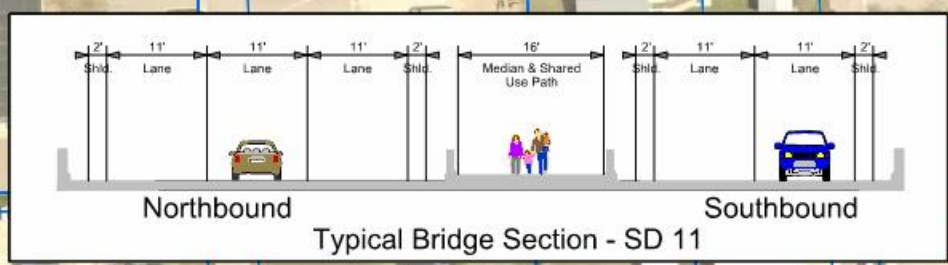

**PROPOSED ACTION**  
DIVERGING DIAMOND INTERCHANGE (DDI)

**I-90 EXIT 406 INTERCHANGE ENVIRONMENTAL ASSESSMENT**  
Brandon, South Dakota